



# West Lodge Park

YOUR LONDON RETREAT



YOUR CELEBRATIONS



# Memorable Events

Known for its spectacular events, West Lodge Park Hotel in North London is the ideal venue for your celebration. With breathtaking views of Enfield Chace, our experienced events team will bring your dream party to life.

Looking to celebrate a special occasion unique to you and your loved ones? We can take care of the details enabling you and your guests to enjoy the moment.

Our creative and experienced events team will create a bespoke event package that marks any occasion. From decorations and audio visual, through to food and drink, your wish list is our challenge.

You'll have a dedicated event coordinator to help you plan the occasion and our banqueting team allocated specifically to your gathering on the day, making sure everything goes to plan.

We have different function rooms, venues and options depending on the size and nature of your party, and will recommend the setting perfect for the big day. From graduations to welcome homes, leaving parties, surprise parties, formal parties and anything else, we'll create a bespoke package for you.



## Christenings

When it comes to celebrating your child's christening, West Lodge Park emerges as the ideal venue choice. From stunning surroundings, beautiful gardens and woodlands for little ones to play in and spaces to cater for parties of all sizes. Our experienced team is dedicated to ensuring that your child's christening is a memorable and meaningful event.



## Bridal Shower

Bridal showers are truly magical occasions, marking significant milestones and life-changing moments in the journey of a family or couple. They offer an opportunity to gather with loved ones, share stories, offer advice, and create lasting memories.

At West Lodge Park, we believe that such moments deserve an extraordinary setting, and our historic estate provides just that. With personalised touches, flexible and varied food and drink packages and impeccable service, we ensure that these special events are as unique and meaningful as the people at the heart of them.



## Birthdays and Anniversaries

Host your next big birthday party or celebrate a milestone anniversary at West Lodge Park for an unforgettable and tailor-made experience. Whether it's a significant age, a cherished tradition, or a surprise for a loved one, we ensure every detail meets your needs. Our venue is ideal for both large gatherings and intimate celebrations, with a focus on making your event truly special.



## Celebration of Life

We believe that honouring the memory of those we love should be a comforting and reflective experience

Our stunning surroundings provide a peaceful haven for guests to contemplate cherished memories and find comfort in a tranquil setting.

From exquisite cuisine and beverages to appropriate music choices, we are committed to ensuring that every detail is tailored to your wishes.

At West Lodge Park, we promote incorporating readings, photographs, and videos to create a truly unique farewell experience that honours your loved one's personality and allows everyone to reminisce and share joyful memories of their life.



## Work Events

We specialise in hosting work events that are not only professional but also fun, memorable, and tailored to the unique tastes and preferences of businesses, whether they are large corporations or small enterprises. Whether you're celebrating hitting a significant target, bidding farewell to a valued colleague with a leaving party, or marking a big milestone for your organisation, West Lodge Park is the perfect venue.

Our versatile event spaces, exceptional catering, and dedicated staff ensure that your work event is a success from start to finish. Let us take care of the details while you focus on achieving your business objectives and creating lasting memories with your team.



## Bat and Bar Mitzvah

At West Lodge Park, we understand the significance of bat and bar mitzvahs in the lives of families, marking a pivotal moment in a young person's journey. Our commitment to making this occasion a true celebration is reflected in our precision, attention to detail, and utmost care. We provide a stunning and accommodating venue, ensuring that every aspect of the event aligns with your family's traditions and wishes. From the decor to the menu, we work closely with you to create a memorable and meaningful celebration that will be cherished for years to come. Our dedicated team is here to support your family in honouring this significant milestone with the respect and joy it deserves.



# Parties Big and Small For All Tastes

At West Lodge Park Hotel, we cater to all styles of party with our diverse dining options. Whatever your vision for your celebration, we'll bring it to life with food, drink and a setting to match. Our events team will walk you through your options.

## Informal Buffets

Enjoy a laid-back yet delectable dining experience with our scrumptious selection of dishes served in a relaxed setting, perfect for mingling and socialising.

## Gala Buffets

Elevate your event with an opulent gala buffet, featuring an array of gourmet delights meticulously prepared to impress your guests and leave a lasting impression.

## Canapé Receptions

Treat your guests to a sophisticated and elegant affair with our exquisite canapé receptions, showcasing a delightful fusion of flavours and textures in bite-sized portions.

## Gourmet Dinners

Indulge in a culinary journey with our gourmet dinners, expertly crafted by our talented chefs to tantalise your taste buds and provide a truly memorable dining experience.

## Barbeque

Embrace the outdoors with our delightful barbeques in the stunning grounds of West Lodge Park Hotel, where you can savour delicious grilled treats amidst the picturesque setting.

## Drinks Receptions

Raise a toast to the occasion with our drinks receptions, offering an assortment of handcrafted beverages and refreshments, ensuring your guests feel truly welcomed.

## Rooms & Suites

We have a variety of event rooms and suites for you to choose from here at West Lodge Park. Whether you require an informal reception for over 100 guests, or a more intimate dining space for four to six people, each of our rooms has its own individual character with lots of natural light.



### Introducing the West Lodge Park Suite

The West Lodge Park Suite comprises of both the John Evelyn Suite and the King Charles Room to give you the ultimate in both size and flexibility. It includes three stunning hotel rooms, two conservatories, two private patios plus a large lawn. Stunning original pieces of art, grand chandeliers and large sash windows make this the perfect space to hold your special event.

You won't find a grander space in London than the West Lodge Park Suite. Perfect for large events, the West Lodge Park Suite is an incredible meeting space that can be extended to allow events for up to 140 guests. The room is absolutely steeped in history. Your guests will find themselves surrounded by lovingly restored period features, such as a fine gold leaf egg and dart cornice, chandeliers, and original 17th century portraits by Britain's first professional female painter, Mary Beale. And let's not forget the high sash windows, from which you can take in the incredible vista of our 35-acre arboretum.

## John Evelyn Suite

This is the finest hotel room for banqueting and conferences in North London, named after the diarist John Evelyn who visited West Lodge in 1676. It features a high ceiling, two large sash windows, air conditioning, chandeliers, original portraits by Mary Beale, a beautiful conservatory and an equally lovely terrace, with direct access to the 35 acres of the Beale Arboretum surrounding the hotel, beautiful views, and easy access to the front entrance.



## King Charles Room

This lovely hotel events room, named after King Charles II whose original portrait by Mary Beale is on the wall, features a nice terrace with direct access to the 35 acres of the Beale Arboretum surrounding the hotel, and has a high ceiling, air conditioning and three large sash windows as well as beautiful views and easy access to the front entrance.



## Coventry Room

This hotel room is named after Henry Coventry, who lived at West Lodge in the seventeenth century and was Secretary of State to Charles II. It features its own conservatory, air conditioning, ceiling fans, and has direct access to the bar terrace and to the 35 acres of the Beale Arboretum surrounding the hotel.







## Edward Beale Room

This hotel event room is named after Edward Beale, the sixth generation of the family firm, who purchased the West Lodge Park in 1945, and whose CBE for Services to Tourism is on show in this room. It features two terraces, a lobby, and air conditioning, and gives direct access to the 35 acres of the Beale Arboretum surrounding the hotel, as well as easy access to the hotel bar and restaurant.



## Lancaster Suite

This fine set of two hotel rooms is named after HM The Queen, who, as the Duke of Lancaster, owns the 1800 acres of the surrounding Enfield Chase. The Lancaster Suite is beautifully decorated with fine landscapes and portraits, chandeliers, air conditioning and statues, and has the largest capacity in the hotel. It features the Lancaster Room and the Chandos Room, with direct access to the front of the hotel and the 35 acres of the Beale Arboretum surrounding the hotel, and easy access to the front entrance.



## Marquees

We can provide fully equipped marquees to suit all your special event needs. Seating up to 200 people on our marquee lawn, with a dedicated bar, furniture, lighting and sounds.



# Garden Pavilion

Our Garden Pavilion is the perfect setting for any occasion, whether it's a corporate event, a wedding, or a special celebration.

With space for up to 100 guests, it offers a spacious and elegant atmosphere that will impress your guests.

Our Pavilion Package includes hire of both the Pavilion and the applicable internal space, a delicious finger buffet or afternoon tea buffet, a selected half bottle of wine per person or glass of Champagne per person, and teas and coffees.

For those who prefer a more flexible option, the Pavilion can also be booked Monday to Friday on a Room Hire basis for a half day.

Please note that our Pavilion package is subject to specific booking criteria based on the number of guests attending. For up to 28 people, we will hold both the Pavilion and either the King Charles or Edward Beale room. For 29-70 people, either the Lancaster or John Evelyn Suite will be available. For larger events of up to 100 guests, our West Lodge Park Suite will be the perfect space.

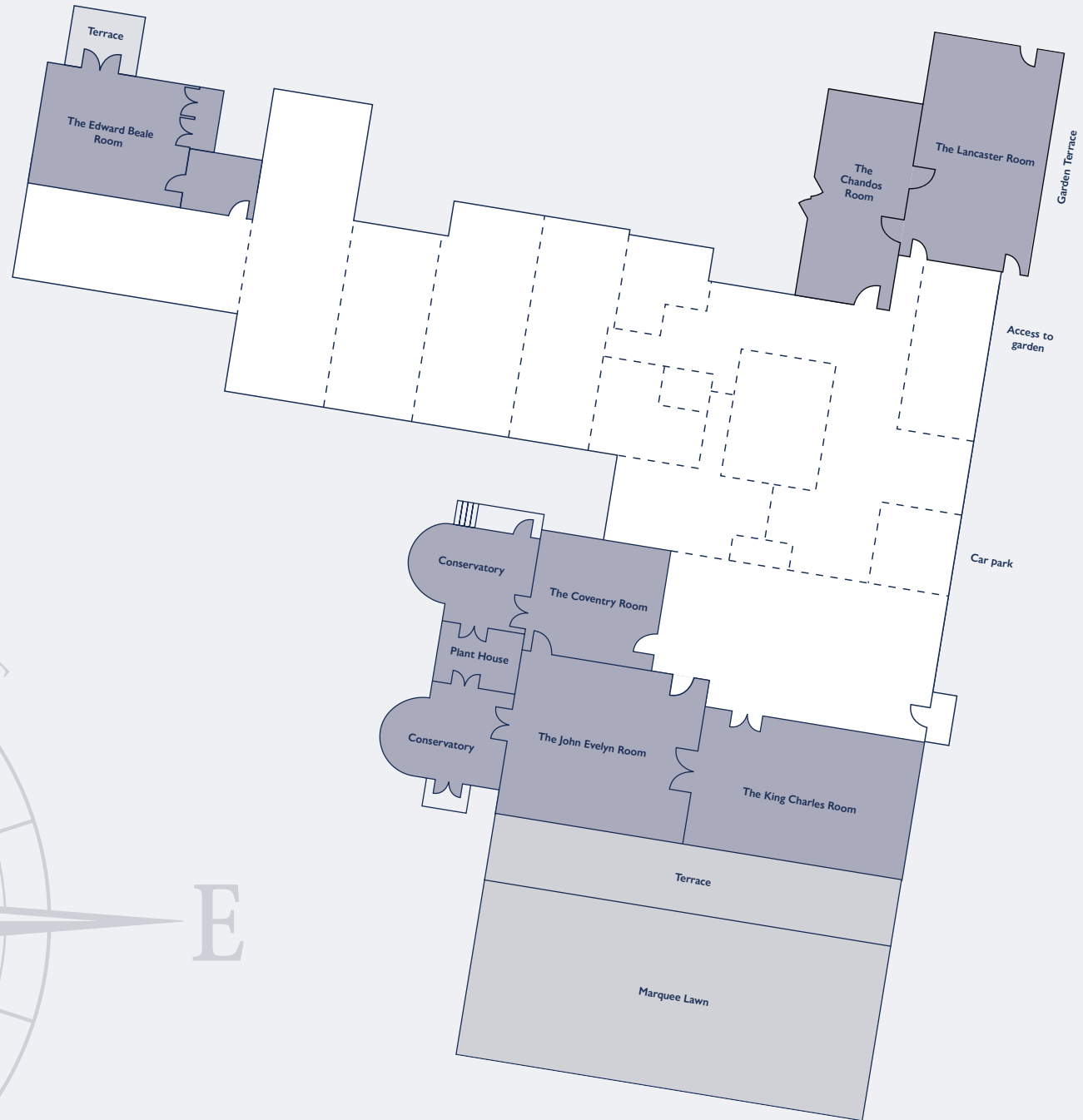

# Capacities

## West Lodge Park Suite

Ceremony	70
Round tables	126
Top table and rounds	125
Top table, sprigs and rounds	129

### Informal Evening Party

For the evening party, your room is transformed to include a dance floor, buffet table and a bar.

## John Evelyn Suite

Ceremony	70
Round tables	99
Top table and rounds	98
Top table, sprigs and rounds	102

### Informal Evening Party

For the evening party your room is transformed to include a dance floor, buffet table and a bar.

## Lancaster Suite

Ceremony	80
Round tables	54
Combination layout	44
Top table and sprigs	60
Oval	30
Informal	60

## King Charles Room

Ceremony	35
Round tables	27
Combination layout	26
Top table and sprigs	26
Oval	20
Informal	30

## Edward Beale Room

Ceremony	35
Round tables	27
Combination layout	26
Top table and sprigs	26
Oval	18
Informal	30

## Marquee

Capacity	200
----------	-----

## Garden Pavilion

Ceremony	100
Informal	100



## The little things

### Food

Whether you are planning an intimate ceremony for a handful of guests or an extravagant gathering for hundreds, the quality and service you will receive from our hospitality team is of the highest calibre.

From the initial planning stages we work with you to ensure that the menu choice will be memorable. Our talented team can recommend seasonal choices and specialities to suit both your taste and your budget.

### Linen

All our linen is white. You may wish to hire chair covers and sashes. We recommend you order these in plenty of time from one of our trusted suppliers.

### Menus, table plan and place cards

We ask you to deliver your final table plan and place cards to the hotel two days prior to your event. Our board for displaying table plans is A1 size. We will supply you with a floor plan so that you can show us where you would like each table positioned in the room and we will also ask you to complete a plan for each individual table so we know where each guest should be seated. We can produce your place cards, menus and table plan for an additional charge. If so, we would request the information seven days before the celebration.

### Children

Children aged twelve and under may eat a smaller portion of the adult menu, which is charged at  $\frac{2}{3}$  of the adult price, or a meal from our children's menu. We have a number of highchairs available. Please request these when meeting with our event co-ordinator four weeks prior to your celebration.

## The small print

### Appointments to discuss your event

We suggest a meeting with our co-ordinator to discuss the details for your wedding takes place four to six weeks prior to the day. Appointments can be made through the Events Office and are available from 8.30am – 6pm Monday to Friday. A limited number of appointments are also available on a Saturday.

### Music

In order to comply with the requirements of our Public Entertainment Licence and for the comfort of our residents, we require music to finish at 11.30pm and the noise levels will be monitored during the event.

### Deposits and payments

An initial non refundable deposit is required to secure your booking. The remaining balance is then due four weeks prior to the event. All balances should be checked and settled on departure. In the unfortunate event that you need to cancel your event, cancellation charges will apply as per our terms and conditions.

### The house and gardens

Some areas of the house and gardens have uneven surfaces and you and your guests should take care. Children must be accompanied by an adult at all times, particularly near the ponds and beehives.

### Special notes

We welcome our guests to enjoy the private open-air terrace, and surrounding gardens. However, we request that guests do not gather in the Main Terrace or Terrace Bar so that we can ensure we meet our commitments to hotel guests while also providing an enjoyable experience for everyone involved.



**West Lodge Park**  
YOUR LONDON RETREAT

## We'd love to hear from you

Our team would love to talk to you about your event!

Please feel free to contact us, we're always happy to answer any questions you may have.

Call us on **020 8216 3943**

or send us an email via [wlpevents@bealeshotels.co.uk](mailto:wlpevents@bealeshotels.co.uk)

**West Lodge Park, Cockfosters Road, Hadley Wood, Enfield EN4 0PY**