

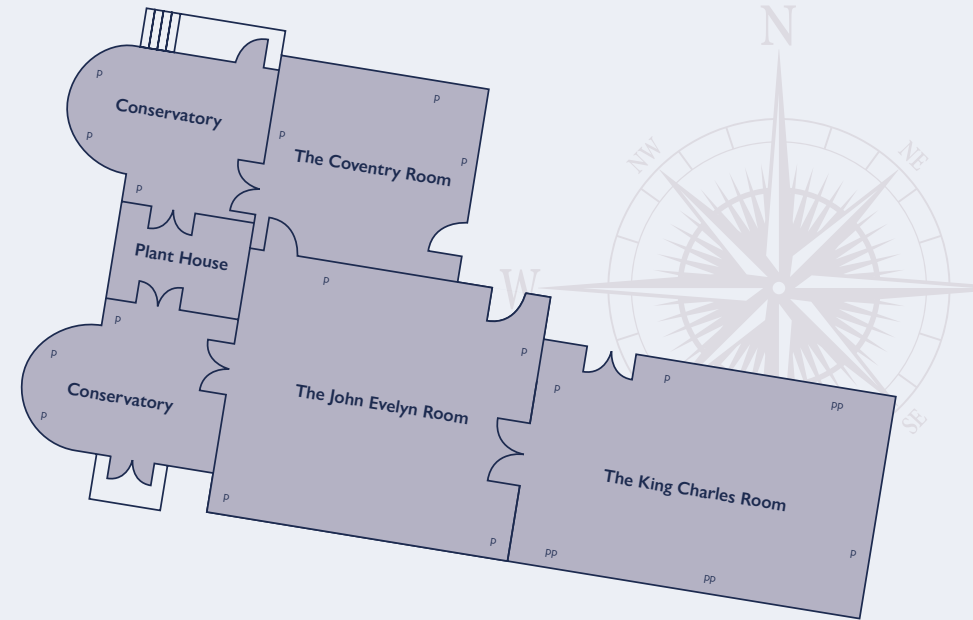

The West Lodge Park Suite

You won't find a grander conference space in London than the West Lodge Park Suite.

Perfect for large events, the West Lodge Park Suite is an incredible meeting space that can be extended to allow events for up to 140 guests. The room is absolutely steeped in history. Your delegates will find themselves surrounded by lovingly restored period features, such as a fine gold leaf egg and dart cornice, chandeliers, and original 17th century portraits by Britain's first professional female painter, our own Mary Beale. And let's not forget the high sash windows, from which you can take in the incredible vista of our 35-acre arboretum.



Capacities

Exhibitions & informal receptions

129

Features

A suite of 5 rooms including the John Evelyn & Conservatory, Coventry & Conservatory plus King Charles, direct access to the grounds.

Suitable for

Larger meetings, exhibitions & informal receptions.

KEY	p power sockets
------------	---------------------------

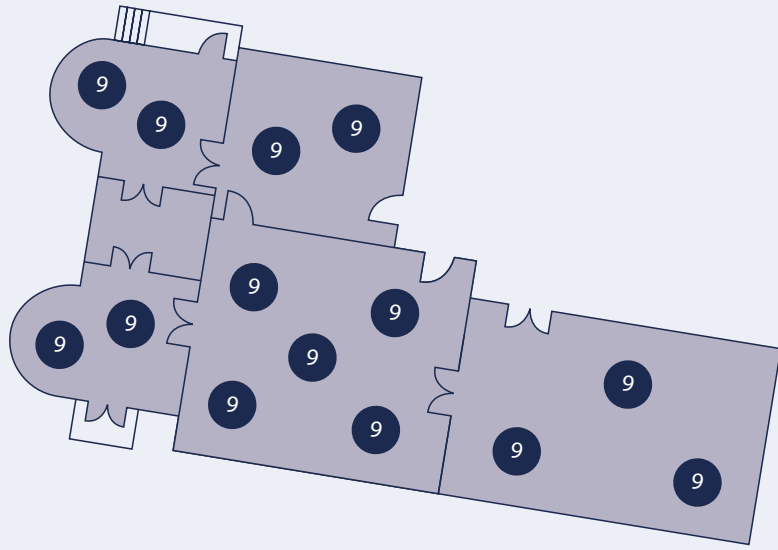

Combination A

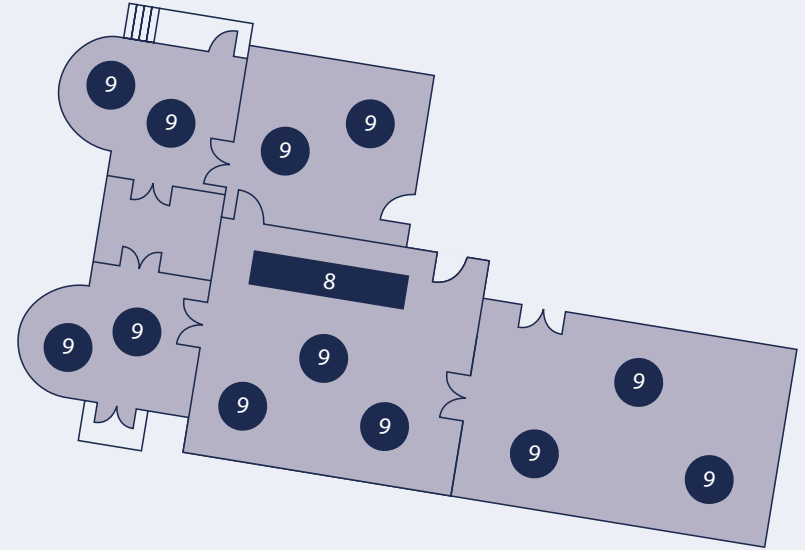

Combination B

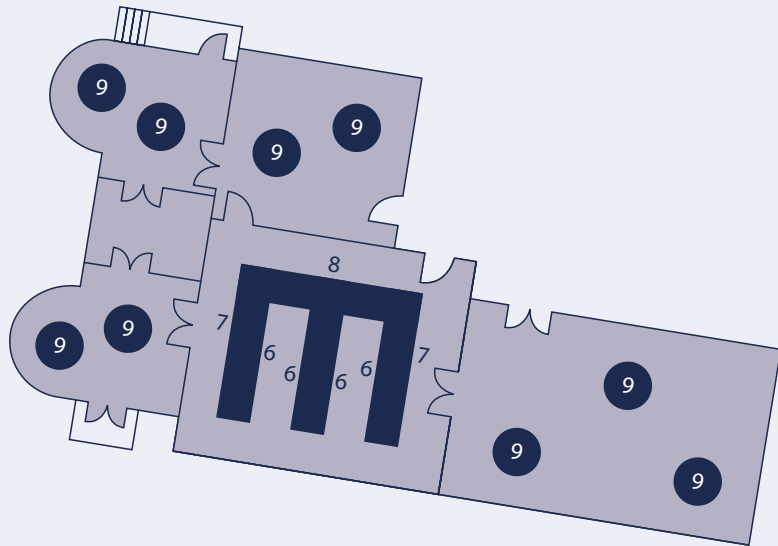

Combination C

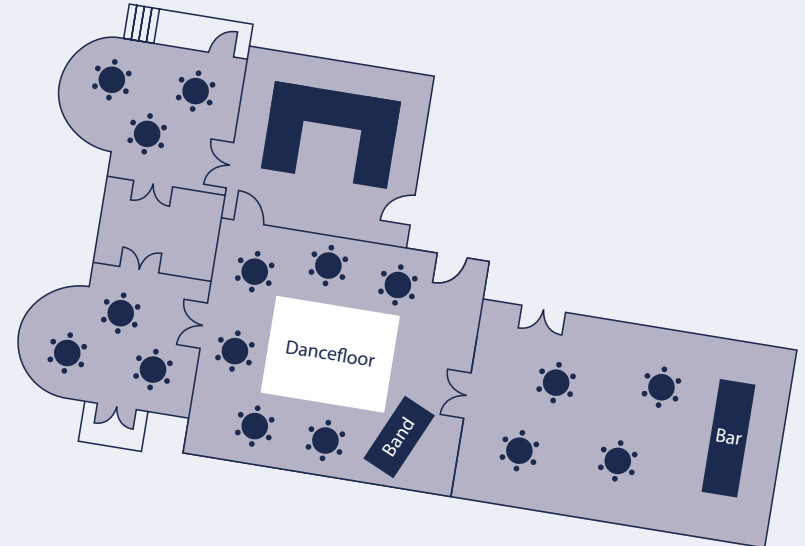

Informal