

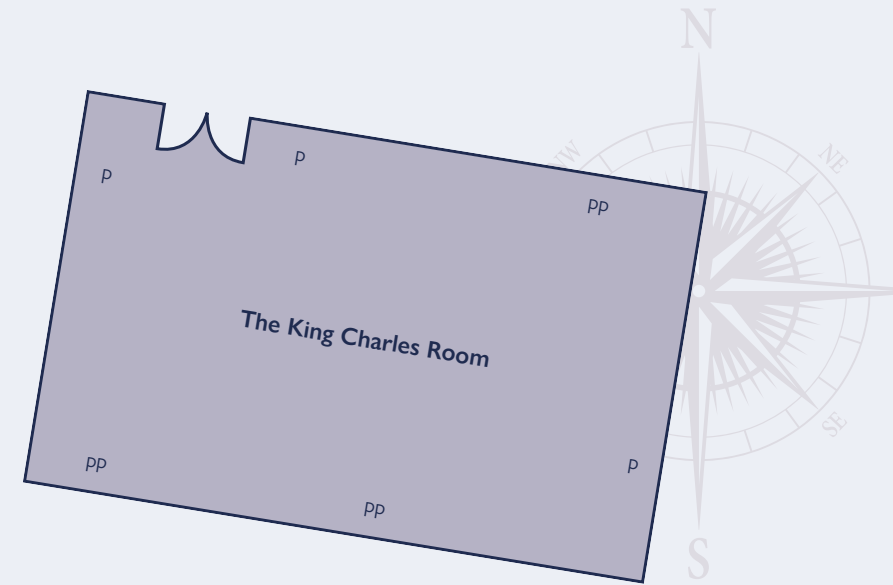

The King Charles Room

This lovely room, named after King Charles II whose original portrait by Mary Beale is on the wall, features a nice terrace with direct access to the 35 acres of the Beale Arboretum surrounding the hotel.

The room has a high ceiling, air conditioning and three large sash windows as well as beautiful views and easy access to the front entrance. This richly decorated room is ideal for a smaller group of family and friends, gathered to witness your wedding ceremony.



Capacities

U-Shape	20
Round Tables	27
Boardroom	20
Classroom	18+2
Theatre Style	34+2

Maximum capacity does not allow for projection equipment.

Features

Dual aspect windows, private terrace area, views of the arboretum.

Suitable for

KEY	P power sockets
------------	---------------------------

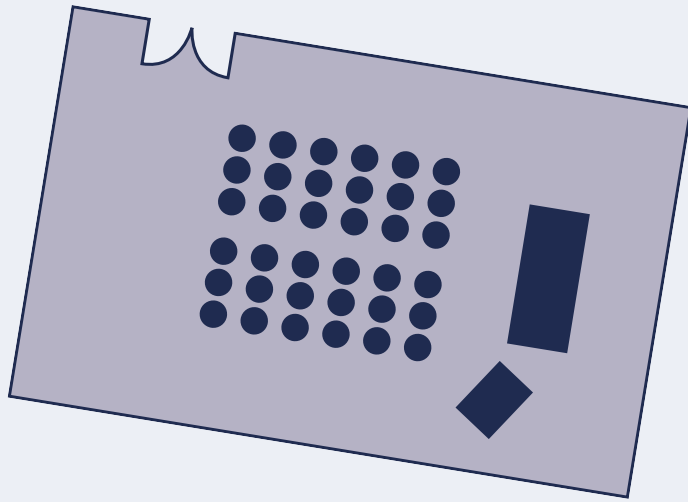

Ceremony

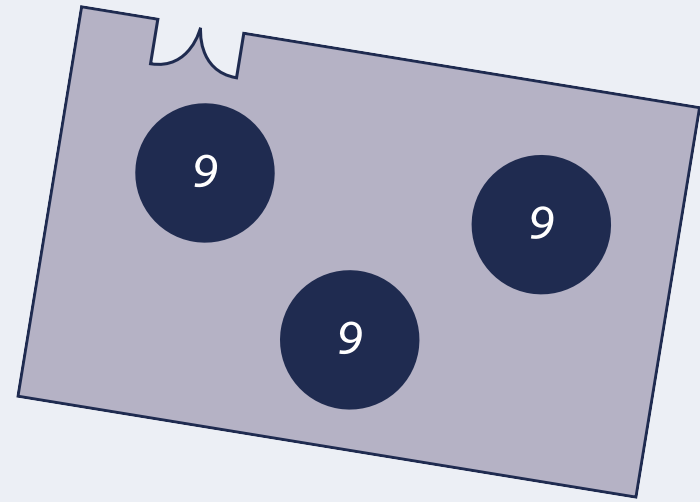

Rounds

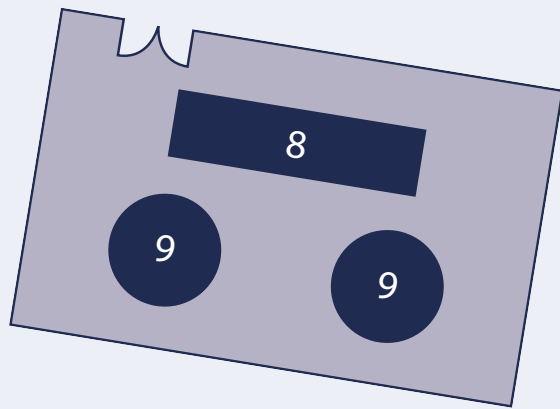

Combination

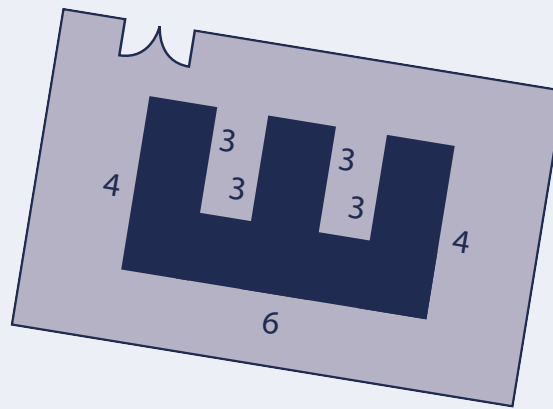

Top Table & Sprigs

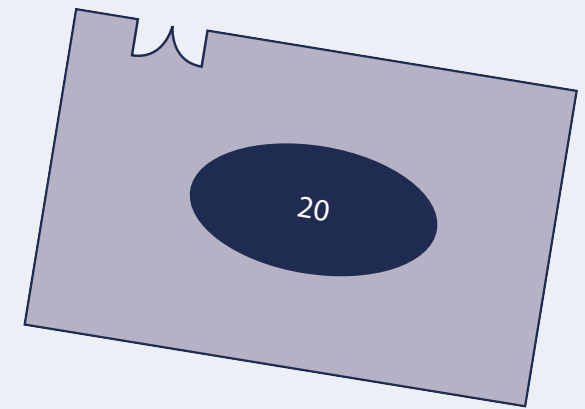

Oval